

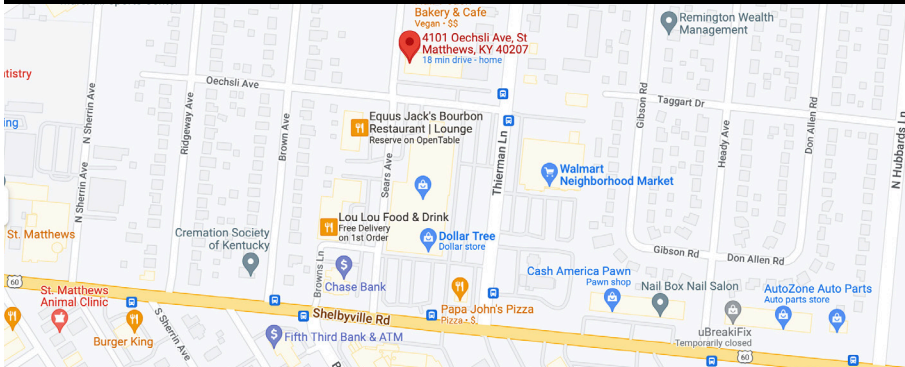



THE GALLERIA OF ST. MATTHEWS

Located at 4101 Oechsli Avenue, The Galleria is situated between Sears and Thierman Avenues with visibility from Shelbyville Road. Kaden's plans to fully redevelop the property, which sits on 2 acres in the heart of St. Matthews, include 23,000 square feet of ground-floor retail space, and a proposed second floor with 4,000 – 10,000 square feet of office or medical space.

 4101 Oechsli Avenue, Saint Matthews, Kentucky 40207



 Leasing Contact



Alexander Blieden

(502) 456-1999 x106
ablieden@kadencompanies.com

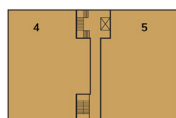
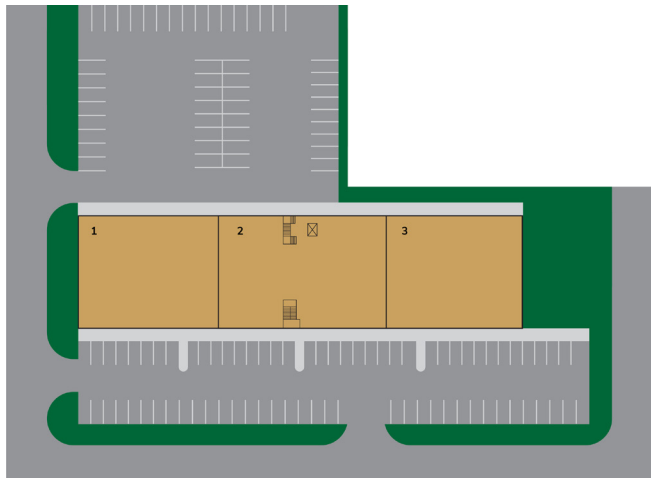

SITE PLAN

SPACE	TENANT	AREA
First Floor	AVAILABLE	23,000 sq ft
Second Floor	AVAILABLE	8,000 sq ft

AVAILABLE FOR LEASE



First Floor

23,000 sq ft



Second Floor

8,000 sq ft



THE PROPERTY

MARKET

Saint Matthews, KY

AREA

30,000 sq ft

SPACES AVAILABLE

2